

# MFX Mastergrip Blind inserts and bolts

Blind inserts and bolts can be used in two ways:

- 1 making thread in thin sheet metals
- 2 as a blind fastener to connect two or more pieces of sheet metal

- The Mastergrip blind insert range is a highly specialized range of blind inserts, offering in our standard stock program a wide variety of
  - Sizes : M3 up to M12
  - Alloys : aluminium, steel, stainless steel (A2)
  - Headtypes : cylindrical, countersunk, reduced countersunk (thin sheet thread)
  - Bodytypes : round, hexagonal, open and closed end.

The Mastergrip blind inserts in steel are equipped with knurled bodies, thus providing higher resistance to torque after setting.

- **ADVANTAGES**
  - Can be easily set in thin material or cylinders. The time consuming tapping of a thread or welding of an insert will now no longer be required.
  - Blind inserts have the same properties as a tapped thread in full material. This is because of their strong "flush flange" and their extra extended thread when compared to normal inserts.
  - Can be set from one side, where the rear of the material and the inside of the object are inaccessible.
  - The material will not be damaged.
  - They will not deform or cause discoloration to the material.

- **APPLICATIONS**

#### *AUTOMOTIVE*

- rear mirrors, sun-visors
- spoilers
- dashboard (glove compartments)
- hinges
- caravans
- repairs
- alarm installation
- ski-boxes and roof-racks

#### *INDUSTRIAL APPLICATIONS AND OTHERS*

- airconditioning
- ventilation-systems
- shipbuilding industry
- (domestic) appliances
- furniture
- window-frames

- We also present the Masterfix Rubnut; a releasable rubber insert and the Masterbolt; a blind riveting bolt providing an external thread-connection.  
For more information on Rubnuts please turn to page 7.22.

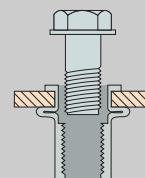
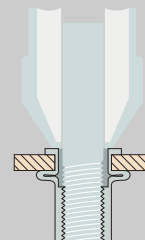
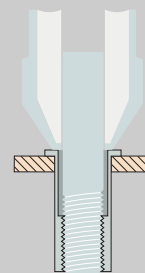

**Blind inserts**  
Blindnietmuttern

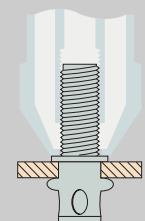
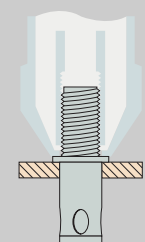
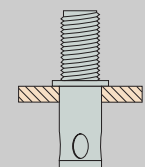

**Blind rivet bolts**  
Blindnietschrauben

# MFX Mastergrip Blindnietmuttern und -schrauben

Blindnietmuttern und -Schrauben können auf zwei verschiedene Weisen genützt werden:

- 1 dünnes Blechmaterial mit einem Gewinde versehen
- 2 als Blindniet zur zusätzlichen Fügeverbindung

● Mastergrip Blindnietmuttern sind ein hochspezialisiertes Sortiment und werden Ihnen in grosser Vielfalt angeboten :

- Abmessungen : M3 bis zu M12
- Legierungen : Alu, Stahl, Edelstahl
- Kopftypen : Flachkopf, Senkkopf, kleiner Senkkopf
- Schaftausführungen : Rundschaft / Hexagonal, offen / geschlossen

Die Mastergrip Blindnietmuttern in Stahl sind ausgerüstet mit einem rillierten Schaft zur Erhöhung des Drehmoments nach dem Setzen.

● **VORTEILE**

- Dünnwandige Platten oder Hohlprofile werden auf einfache Weise mit einem Gewinde versehen. Gewinde schneiden im – oft zu dünnen – Blech entfällt.
- Blindnietmuttern und -schrauben weisen die gleichen Werte wie ein in Vollmaterial geschnittenes Gewinde auf. Einerseits wegen dem starken Stauchkragen, andererseits wegen dem extra langen Gewinde im Vergleich zu normalen Muttern.
- Sie können von einer Seite verarbeitet werden ohne daß die Innenseite zugänglich sein muß.
- Die bearbeitete Oberfläche wird nicht beschädigt.
- Keine Verformung oder Verfärbung des Materials wie beim Schweißen von Muttern oder Bolzen.

● **ANWENDUNGEN**

*AUTOMOBILBEREICH*

- Innen- und Außenspiegel, Sonnenblende
- Sitzkonsolen und Spoiler usw.
- Handschuhfach
- Scharniere
- Wohnwagenbau
- Reparaturen
- Alarm Anlagen
- Ski-Behälter und Dachgepäckträger

*INDUSTRIELLE ANWENDUNGEN UND SONSTIGES*

- Luftkühler
- Ventilationsysteme
- Schiffs- und Jachtbau
- Geräte- und Schrankbau
- Fensterbau
- Möbelindustrie
- Haushaltsgeräte

● Weiter präsentieren wir Ihnen die Masterfix Rubnuts, eine lösbare Neopren Einnietmutter, und Masterbolt, die Blindnietschraube die Ihre Verbindung mit Aussengewinde versieht. Für weitere Informationen über die Rubnuts, bitte sehe Seite 7.22



**steel** zinc coated (yellow passivated)

**Stahl** gelb verzinkt

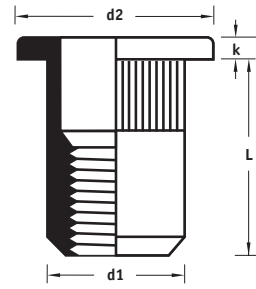

	L		Art.	□	⊞
<b>M3</b>	10.0	0.5 - 3.0	23M03C030	250	10000
<b>M4</b>	10.0	0.3 - 3.0	23M04C030	250	10000
	11.5	3.1 - 4.0	23M04C040		
<b>M5</b>	12.0	0.3 - 3.0	23M05C030	250	5000
	15.0	3.1 - 4.0	23M05C040		
<b>M6</b>	14.5	0.5 - 3.0	23M06C030	250	3000
	16.0	3.1 - 4.5	23M06C045		
<b>M8</b>	16.0	0.5 - 3.0	23M08C030	250	2000
	18.5	3.1 - 5.5	23M08C055		
<b>M10</b>	17.0	0.5 - 3.0	23M10C030	250	1500
	22.0	3.0 - 6.0	23M10C060		
<b>M12</b>	23.0	1.0 - 4.0	23M12C040	250	1000

$\varnothing$  : 5.0  
 d1  $\varnothing$  : 4.9  
 d2  $\varnothing$  : 7.0  
 k : 0.9

$\varnothing$  : 6.0  
 d1  $\varnothing$  : 5.9  
 d2  $\varnothing$  : 9.0  
 k : 1.0

$\varnothing$  : 7.0  
 d1  $\varnothing$  : 6.9  
 d2  $\varnothing$  : 10.0  
 k : 1.0

$\varnothing$  : 9.0  
 d1  $\varnothing$  : 8.9  
 d2  $\varnothing$  : 12.0  
 k : 1.5

$\varnothing$  : 11.0  
 d1  $\varnothing$  : 10.9  
 d2  $\varnothing$  : 15.0  
 k : 1.5

$\varnothing$  : 12.0  
 d1  $\varnothing$  : 11.9  
 d2  $\varnothing$  : 16.0  
 k : 2.0

$\varnothing$  : 16.0  
 d1  $\varnothing$  : 15.9  
 d2  $\varnothing$  : 22.0  
 k : 2.0

Larger clamping capacities are available on request

Größere Klemmbereiche sind auf Anfrage lieferbar



**steel** zinc coated (yellow passivated)

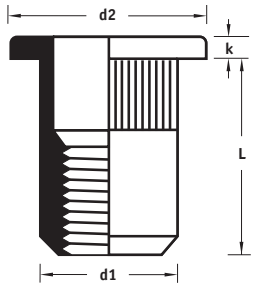

MASTERGRIP | Rundschaft offen | Flachkopf (mit Rändelung)

**Stahl** gelb verzinkt

<p>ø : 6.0 d1 ø : 5.9 d2 ø : 9.0 k : 1.0</p>
<p>ø : 7.0 d1 ø : 6.9 d2 ø : 10.0 k : 1.0</p>
<p>ø : 9.0 d1 ø : 8.9 d2 ø : 12.0 k : 1.5</p>
<p>ø : 11.0 d1 ø : 10.9 d2 ø : 15.0 k : 1.5</p>

	L		Art.	□
<b>M4</b>	10.0	0.3 - 3.0	23M04C0302	50
<b>M5</b>	12.0	0.3 - 3.0	23M05C0302	50
<b>M6</b>	14.5	0.5 - 3.0	23M06C0302	50
<b>M8</b>	16.0	0.5 - 3.0	23M08C0302	50



Blister

**steel** zinc coated (yellow passivated)

MASTERGRIP | Rundschaft offen | Senkkopf (mit Rändelung)

**Stahl** gelb verzinkt

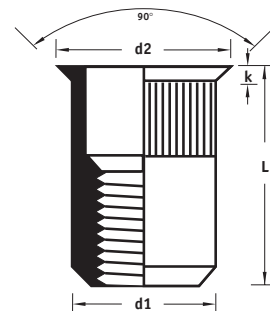

	L		Art.	□	⊞
<b>M4</b>	11.5	2.0 - 3.5	23M04V035	250	10000
<b>M5</b>	13.5	2.0 - 4.0	23M05V040	250	5000
<b>M6</b>	16.0	2.0 - 4.5	23M06V045	250	3000
<b>M8</b>	19.0	2.0 - 4.5	23M08V045	250	2000
<b>M10</b>	21.0	2.0 - 4.5	23M10V045	250	1500



ø : 6.0  
d1 ø : 5.9  
d2 ø : 9.0  
k : 1.5

ø : 7.0  
d1 ø : 6.9  
d2 ø : 10.0  
k : 1.5

ø : 9.0  
d1 ø : 8.9  
d2 ø : 12.0  
k : 1.5

ø : 11.0  
d1 ø : 10.9  
d2 ø : 14.0  
k : 1.5

ø : 12.0  
d1 ø : 11.9  
d2 ø : 14.7  
k : 1.5

Larger clamping capacities are available on request

Größere Klemmbereiche sind auf Anfrage lieferbar

**steel** zinc coated (yellow passivated)

MASTERGRIP | Rundschaft offen | Kleiner Senkkopf (mit Rändelung)

**Stahl** gelb verzinkt

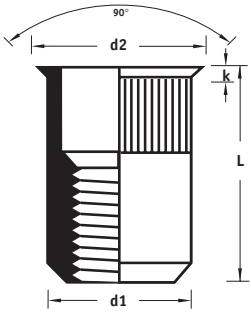

<p>ø : 6.0 d1 ø : 5.9 d2 ø : 7.0 k : 0.6</p>
<p>ø : 7.0 d1 ø : 6.9 d2 ø : 8.0 k : 0.6</p>
<p>ø : 9.0 d1 ø : 8.9 d2 ø : 10.0 k : 0.6</p>
<p>ø : 11.0 d1 ø : 10.9 d2 ø : 12.0 k : 0.6</p>
<p>ø : 12.0 d1 ø : 11.9 d2 ø : 13.5 k : 0.8</p>

	L		Art.	□	⊞
<b>M4</b>	<b>10.0</b>	0.5 - 3.0	<b>27M04V030</b>	250	10000
<b>M5</b>	<b>11.5</b>	0.5 - 3.0	<b>27M05V030</b>	250	5000
<b>M6</b>	<b>14.0</b>	0.5 - 3.0	<b>27M06V030</b>	250	3000
<b>M8</b>	<b>15.5</b>	0.5 - 3.0	<b>27M08V030</b>	250	2000
<b>M10</b>	<b>20.0</b>	0.8 - 3.5	<b>27M10V035</b>	250	1500



**steel** zinc coated (yellow passivated)

MASTERGRIP | Rundschaft offen | Kleiner Senkkopf | ABM. IN INCH

**Stahl** gelb verzinkt

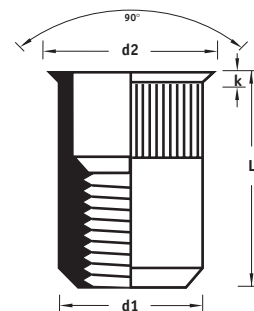

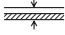
	L		Art.	□	⊞
<b>M3</b>	9.0	0.5 - 1.5	26M03V015	250	10000
<b>M4</b>	10.4	0.5 - 1.5	26M04V015	250	10000
<b>M5</b>	12.0	0.5 - 2.0	26M05V020	250	5000
<b>M6</b>	15.0	0.8 - 2.5	26M06V025	250	3000
<b>M8</b>	16.0	1.0 - 3.0	26M08V030	250	2000

$\varnothing$  : 4.8  
 d1  $\varnothing$  : max. 4.8  
 d2  $\varnothing$  : max. 5.5  
 k : max. 0.45

$\varnothing$  : 6.4  
 d1  $\varnothing$  : max. 6.3  
 d2  $\varnothing$  : max. 7.4  
 k : max. 0.55

$\varnothing$  : 7.2  
 d1  $\varnothing$  : max. 7.11  
 d2  $\varnothing$  : max. 8.3  
 k : max. 0.65

$\varnothing$  : 9.6  
 d1  $\varnothing$  : max. 9.45  
 d2  $\varnothing$  : max. 10.7  
 k : max. 1.0

$\varnothing$  : 10.6  
 d1  $\varnothing$  : max. 10.5  
 d2  $\varnothing$  : max. 11.7  
 k : max. 0.75



**steel** zinc coated (yellow passivated)

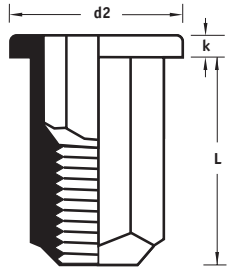

MASTERGRIP | Sechskantschaft offen HEX-F | Flachkopf

**Stahl** gelb verzinkt

SW : 6.0
SW 1: 6.1
SE : 6.8
d2 ø : 9.3
k : 1.0
SW : 7.0
SW 1: 7.1
SE : 7.9
d2 ø : 10.3
k : 1.0
SW : 9.0
SW 1: 9.1
SE : 10.2
d2 ø : 12.3
k : 1.5
SW : 11.0
SW 1: 11.1
SE : 12.4
d2 ø : 14.3
k : 1.5

	L		Art.	□	⊞
<b>M4</b>	11.5	0.5 - 3.0	23H04C030	250	5000
<b>M5</b>	13.5	0.5 - 3.0	23H05C030	250	5000
<b>M6</b>	15.5	0.5 - 3.0	23H06C030	250	3000
<b>M8</b>	17.5	0.5 - 3.0	23H08C030	250	2000
<b>M10</b>	22.0	1.0 - 4.0	23H10C040	250	1500

Masterfix also offers punching tools for hexagonal holes.

Masterfix liefert auch Stanzergeräte für Sechskantlöcher.

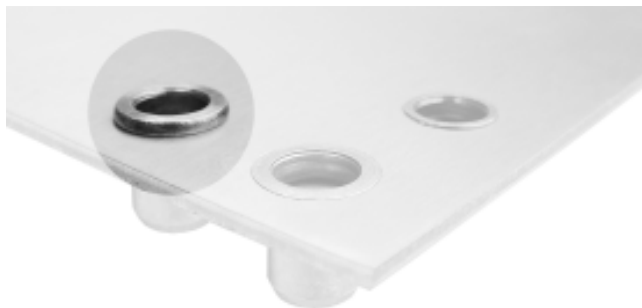
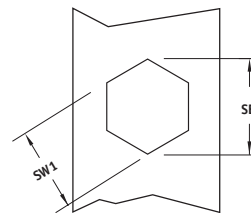
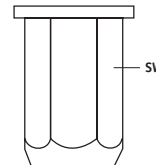



**steel** zinc coated (yellow passivated)

MASTERGRIP | Sechskantschaft offen HEX-F | Kleiner Senkkopf

**Stahl** gelb verzinkt

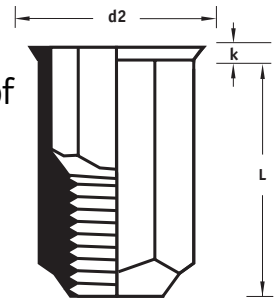

	L		Art.	□	⊞
<b>M4</b>	12.0	0.5 - 2.5	23H04KV025	250	10000
<b>M5</b>	14.0	0.5 - 2.5	23H05KV025	250	5000
<b>M6</b>	16.0	0.5 - 2.5	23H06KV025	250	3000
<b>M8</b>	18.0	0.5 - 2.5	23H08KV025	250	2000

SW : 6.0  
 SW 1: 6.1 (SW+0,1)  
 SE : 6.8  
 d2 ø : 7.0  
 k : 0.8

SW : 7.0  
 SW 1: 7.1 (SW+0,1)  
 SE : 7.9  
 d2 ø : 8.0  
 k : 0.8

SW : 9.0  
 SW 1: 9.1 (SW+0,1)  
 SE : 10.2  
 d2 ø : 10.0  
 k : 0.8

SW : 11.0  
 SW 1: 11.1 (SW+0,1)  
 SE : 12.4  
 d2 ø : 12.0  
 k : 0.8

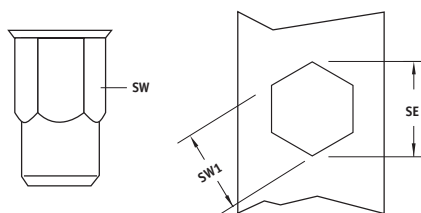

Masterfix also offers punching tools for hexagonal holes.

Masterfix liefert auch Stanzgeräte für Sechskantlöcher.

open type HEX-T | cylindrical head

**steel** zinc coated

Sechskantschaft offen HEX-T | Flachkopf

**Stahl** verzinkt

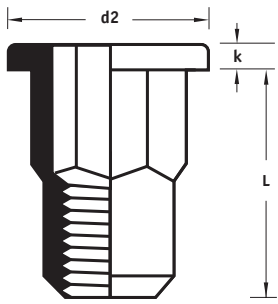

SW : 5.9
SW1 : 6.0 (SW+0,1)
SE : 6.6
d2 ø : 9.0
k : 0.8
SW : 6.9
SW1 : 7.0 (SW+0,1)
SE : 7.65
d2 ø : 10.0
k : 1.0
SW : 8.9
SW1 : 9.0 (SW+0,1)
SE : 9.8
d2 ø : 13.0
k : 1.5
SW : 10.9
SW1 : 11.0 (SW+0,1)
SE : 12.0
d2 ø : 16.0
k : 1.5

	L		Art.	□
<b>M4</b>	9.7	0.5 - 2.0	2COHT04C020	250
<b>M5</b>	13.0	0.5 - 3.0	2COHT05C030	250
<b>M6</b>	14.5	0.5 - 3.0	2COHT06C030	250
<b>M8</b>	15.5	0.5 - 3.0	2COHT08C030	250

Masterfix also offers punching tools for hexagonal holes.

Masterfix liefert auch Stanzgeräte für Sechskantlöcher.

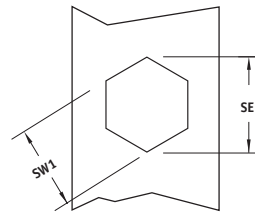
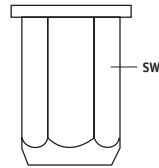

**steel** zinc coated (yellow passivated)

MASTERGRIP | Rundschaft geschlossen | Flachkopf (mit Rändelung)

**Stahl** gelb verzinkt

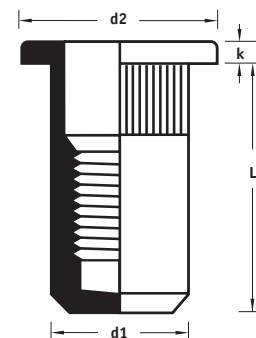

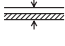
	L		Art.	□	⊞
<b>M4</b>	15.5	0.3 - 3.0	23M04CG30	250	5000
<b>M5</b>	18.0	0.3 - 3.0	23M05CG30	250	5000
<b>M6</b>	20.5	0.5 - 3.0	23M06CG30	250	3000
<b>M8</b>	25.0	0.5 - 3.0	23M08CG30	250	2000

$\varnothing$  : 6.0  
 d1  $\varnothing$  : 5.9  
 d2  $\varnothing$  : 9.0  
 k : 1.0

$\varnothing$  : 7.0  
 d1  $\varnothing$  : 6.9  
 d2  $\varnothing$  : 10.0  
 k : 1.0

$\varnothing$  : 9.0  
 d1  $\varnothing$  : 8.9  
 d2  $\varnothing$  : 12.0  
 k : 1.5

$\varnothing$  : 11.0  
 d1  $\varnothing$  : 10.9  
 d2  $\varnothing$  : 15.0  
 k : 1.5



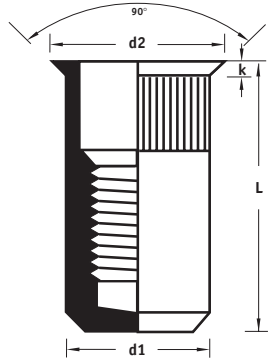

**steel** zinc coated (yellow passivated)

MASTERGRIP | Rundschaft geschlossen | Senkkopf (mit Rändelung)

**Stahl** gelb verzinkt

<p>ø : 6.0 d1 ø : 5.9 d2 ø : 9.0 k : 1.5</p>
<p>ø : 7.0 d1 ø : 6.9 d2 ø : 10.0 k : 1.5</p>
<p>ø : 9.0 d1 ø : 8.9 d2 ø : 12.0 k : 1.5</p>
<p>ø : 11.0 d1 ø : 10.9 d2 ø : 14.0 k : 1.5</p>



	L		Art.	□	⊞
<b>M4</b>	<b>17.5</b>	2.0 - 3.5	<b>23M04VG35</b>	250	5000
<b>M5</b>	<b>20.5</b>	2.0 - 4.0	<b>23M05VG40</b>	250	5000
<b>M6</b>	<b>23.5</b>	2.0 - 4.5	<b>23M06VG45</b>	250	3000
<b>M8</b>	<b>28.0</b>	2.0 - 4.5	<b>23M08VG45</b>	250	2000

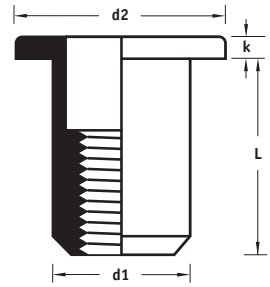

**stainless steel** A2 [1.4567]

**Edelstahl** A2 [1.4567]

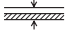

	L		Art.	□	
<b>M4</b>	10.0	0.3 - 2.5	24M04C025	250	10000
	11.5	2.5 - 4.0	24M04C040		
<b>M5</b>	12.0	0.3 - 3.0	24M05C030	250	5000
	13.5	3.1 - 4.0	24M05C040		
<b>M6</b>	14.5	0.5 - 3.0	24M06C030	250	3000
	16.0	3.1 - 4.5	24M06C045		
<b>M8</b>	16.0	0.5 - 3.0	24M08C030	250	2000
	18.5	3.1 - 5.5	24M08C055		
<b>M10</b>	17.0	0.5 - 3.0	24M10C030	250	1500
	20.0	3.1 - 5.5	24M10C055		



$\varnothing$  : 6.0  
 d1  $\varnothing$  : 5.9  
 d2  $\varnothing$  : 9.0  
 k : 1.0

$\varnothing$  : 7.0  
 d1  $\varnothing$  : 6.9  
 d2  $\varnothing$  : 10.0  
 k : 1.0

$\varnothing$  : 9.0  
 d1  $\varnothing$  : 8.9  
 d2  $\varnothing$  : 12.0  
 k : 1.5

$\varnothing$  : 11.0  
 d1  $\varnothing$  : 10.9  
 d2  $\varnothing$  : 15.0  
 k : 1.5

$\varnothing$  : 13.0  
 d1  $\varnothing$  : 12.9  
 d2  $\varnothing$  : 16.0  
 k : 2.0

Larger clamping capacities are available on request

Größere Klemmbereiche sind auf Anfrage lieferbar

**stainless steel** A2 [1.4567]

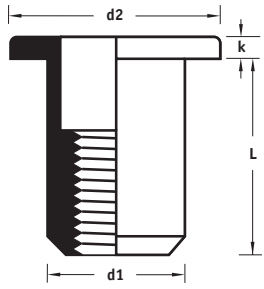

MASTERGRIP | Rundschaft offen | Flachkopf

**Edelstahl** A2 [1.4567]

<p>ø : 6.0 d1 ø : 5.9 d2 ø : 9.0 k : 1.0</p>
<p>ø : 7.0 d1 ø : 6.9 d2 ø : 10.0 k : 1.0</p>
<p>ø : 9.0 d1 ø : 8.9 d2 ø : 12.0 k : 1.5</p>
<p>ø : 11.0 d1 ø : 10.9 d2 ø : 15.0 k : 1.5</p>

	L		Art.	□
<b>M4</b>	10.0	0.3 - 2.5	24M04C0252	50
<b>M5</b>	12.0	0.3 - 3.0	24M05C0302	50
<b>M6</b>	14.5	0.5 - 3.0	24M06C0302	50
<b>M8</b>	16.0	0.5 - 3.0	24M08C0302	50



Blister

**stainless steel** A2 [1.4567]

MASTERGRIP | Rundschaft offen | Senkkopf

**Edelstahl** A2 [1.4567]

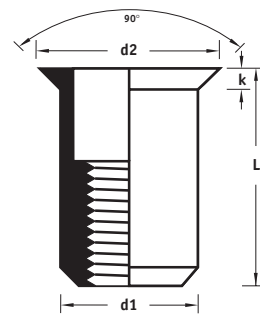

	L		Art.	□	
<b>M4</b>	11.5	2.0 - 3.5	24M04V035	250	10000
<b>M5</b>	13.5	2.0 - 4.0	24M05V040	250	5000
<b>M6</b>	16.0	2.0 - 4.5	24M06V045	250	3000
<b>M8</b>	19.0	2.0 - 4.5	24M08V045	250	2000
<b>M10</b>	21.0	2.0 - 4.5	24M10V045	250	1500

$\varnothing$  : 6.0  
 d1  $\varnothing$  : 5.9  
 d2  $\varnothing$  : 9.0  
 k : 1.5

$\varnothing$  : 7.0  
 d1  $\varnothing$  : 6.9  
 d2  $\varnothing$  : 10.0  
 k : 1.5

$\varnothing$  : 9.0  
 d1  $\varnothing$  : 8.9  
 d2  $\varnothing$  : 12.0  
 k : 1.5

$\varnothing$  : 11.0  
 d1  $\varnothing$  : 10.9  
 d2  $\varnothing$  : 14.0  
 k : 1.5

$\varnothing$  : 13.0  
 d1  $\varnothing$  : 12.9  
 d2  $\varnothing$  : 16.0  
 k : 1.5



**stainless steel** A2 [1.4567]

MASTERGRIP | Rundschaft offen | Kleiner Senkkopf

**Edelstahl** A2 [1.4567]

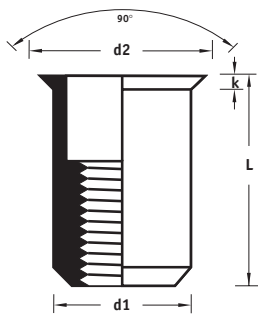

<p>ø : 6.0                  d1 ø : 5.9                  d2 ø : 7.0                  k : 0.6</p>
<p>ø : 7.0                  d1 ø : 6.9                  d2 ø : 8.0                  k : 0.6</p>
<p>ø : 9.0                  d1 ø : 8.9                  d2 ø : 10.0                  k : 0.6</p>
<p>ø : 11.0                  d1 ø : 10.9                  d2 ø : 12.0                  k : 0.6</p>
<p>ø : 13.0                  d1 ø : 12.9                  d2 ø : 14.5                  k : 0.8</p>

	L		Art.	□	⊞
<b>M4</b>	10.0	0.5 - 2.5	24M04KV025	250	10000
<b>M5</b>	11.5	0.5 - 3.0	24M05KV030	250	5000
<b>M6</b>	14.0	0.5 - 3.0	24M06KV030	250	3000
<b>M8</b>	15.5	0.5 - 3.0	24M08KV030	250	2000
<b>M10</b>	19.5	0.8 - 3.5	24M10KV035	250	1500





**stainless steel** A2 [1.4567]

**Edelstahl** A2 [1.4567]

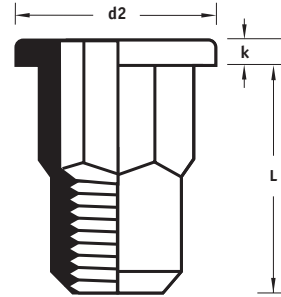

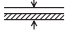
	L		Art.	□	⊞
<b>M4</b>	11.5	0.5 - 2.5	24H04C025	250	10000
<b>M5</b>	13.5	0.5 - 3.0	24H05C030	250	5000
<b>M6</b>	15.5	0.5 - 3.0	24H06C030	250	3000
<b>M8</b>	17.5	0.5 - 3.0	24H08C030	250	2000
<b>M10</b>	22.0	1.0 - 4.0	24H10C040	250	1500

Masterfix also offers  
punching tools for  
hexagonal holes

Masterfix liefert auch  
Stanzgeräte für  
Sechskantlöcher

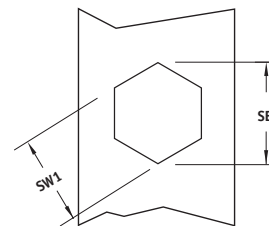
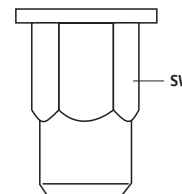

SW : 6.0  
SW1 : 6.1 (SW+0,1)  
SE : 6.8  
d2 ø : 9.3  
k : 1.0

SW : 7.0  
SW1 : 7.1 (SW+0,1)  
SE : 7.9  
d2 ø : 10.3  
k : 1.0

SW : 9.0  
SW1 : 9.1 (SW+0,1)  
SE : 10.2  
d2 ø : 12.3  
k : 1.5

SW : 11.0  
SW1 : 11.1 (SW+0,1)  
SE : 12.4  
d2 ø : 14.3  
k : 1.5

SW : 13.0  
SW1 : 13.1 (SW+0,1)  
SE : 14.7  
d2 ø : 16.3  
k : 2.0



**stainless steel** A2 [1.4567]

MASTERGRIP | Sechskantschaft offen HEX-T | Kleiner Senkkopf

**Edelstahl** A2 [1.4567]

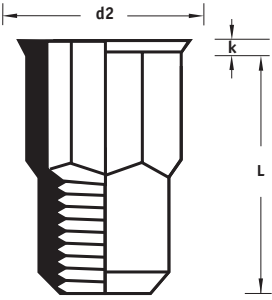

SW : 6.0
SW1 : 6.1 (SW+0,1)
SE : 6.8
d2 ø : 6.5
k : 0.6
SW : 7.0
SW1 : 7.1 (SW+0,1)
SE : 7.9
d2 ø : 7.5
k : 0.6
SW : 9.0
SW1 : 9.1 (SW+0,1)
SE : 10.2
d2 ø : 9.5
k : 0.6
SW : 11.0
SW1 : 11.1 (SW+0,1)
SE : 12.4
d2 ø : 11.5
k : 0.6

	L		Art.	□	⊞
<b>M4</b>	12.0	0.5 - 2.5	24H04KV025	250	10000
<b>M5</b>	14.0	0.5 - 3.0	24H05KV030	250	5000
<b>M6</b>	16.0	0.5 - 3.0	24H06KV030	250	3000
<b>M8</b>	17.0	0.5 - 3.0	24H08KV030	250	2000
<b>M10</b>	20.5	1.0 - 4.0	24H10KV040	250	1500

Masterfix also offers  
punching tools for  
hexagonal holes

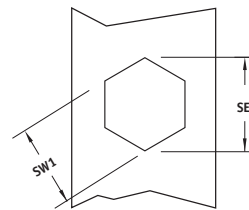
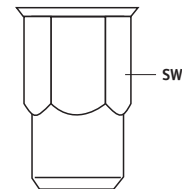

Masterfix liefert auch  
Stanzgeräte für  
Sechskantlöcher

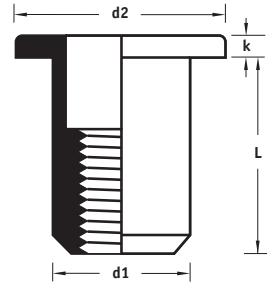

**aluminium** AlMg 5 [3.3555]

**Aluminium** AlMg 5 [3.3555]

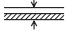

	L		Art.	□	
<b>M4</b>	10.2	0.5 - 1.5	22M04C015	250	10000
	11.2	1.5 - 2.5	C025		
	12.2	2.5 - 3.5	C035		
<b>M5</b>	11.0	0.5 - 1.5	22M05C015	250	5000
	12.0	1.5 - 2.5	C025		
	13.0	2.5 - 3.5	C035		
<b>M6</b>	14.0	1.0 - 2.5	22M06C025	250	3000
	15.5	2.5 - 4.0	C040		
<b>M8</b>	15.5	1.0 - 2.5	22M08C025	250	2000
	17.0	2.5 - 4.0	C040		
<b>M10</b>	16.0	1.0 - 2.5	22M10C025	250	1500
	17.5	2.5 - 4.0	C040		



$\varnothing$  : 6.1  
 d1  $\varnothing$  : 6.0  
 d2  $\varnothing$  : 9.3  
 k : 0.8

$\varnothing$  : 7.1  
 d1  $\varnothing$  : 7.0  
 d2  $\varnothing$  : 10.3  
 k : 1.0

$\varnothing$  : 9.1  
 d1  $\varnothing$  : 9.0  
 d2  $\varnothing$  : 12.3  
 k : 1.5

$\varnothing$  : 11.1  
 d1  $\varnothing$  : 11.0  
 d2  $\varnothing$  : 14.3  
 k : 1.5

$\varnothing$  : 13.1  
 d1  $\varnothing$  : 13.0  
 d2  $\varnothing$  : 16.3  
 k : 1.5

Larger clamping capacities are available on request

Größere Klemmbereiche sind auf Anfrage lieferbar

**aluminium** AlMg 5 [3.3555]

**Aluminium** AlMg 5 [3.3555]

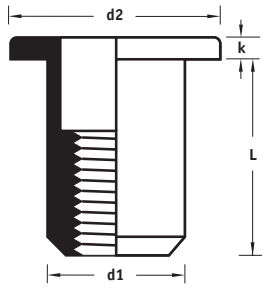

ø : 6.1  
d1 ø : 6.0  
d2 ø : 9.3  
k : 0.8

ø : 7.1  
d1 ø : 7.0  
d2 ø : 10.3  
k : 1.0

ø : 9.1  
d1 ø : 9.0  
d2 ø : 12.3  
k : 1.5

ø : 11.1  
d1 ø : 11.0  
d2 ø : 14.3  
k : 1.5

	L		Art.	□
<b>M4</b>	<b>11.2</b>	1.5 - 2.5	<b>22M04C0252</b>	50
<b>M5</b>	<b>12.0</b>	1.5 - 2.5	<b>22M05C0252</b>	50
<b>M6</b>	<b>14.0</b>	1.0 - 2.5	<b>22M06C0252</b>	50
<b>M8</b>	<b>15.5</b>	1.0 - 2.5	<b>22M08C0252</b>	50



Blister

**aluminium** AlMg 5 [3.3555]

MASTERGRIP | Rundschaft offen | Kleiner Senkkopf

**Aluminium** AlMg 5 [3.3555]

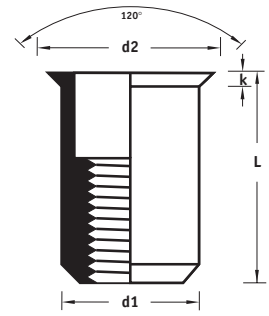

	L		Art.	□	
<b>M4</b>	10.5	0.5 - 1.5	21M04V015	250	10000
	11.5	1.5 - 2.5	V025		
	12.5	2.5 - 3.5	V035		
<b>M5</b>	11.0	0.5 - 1.5	21M05V015	250	5000
	12.0	1.5 - 2.5	V025		
	13.0	2.5 - 3.5	V035		
<b>M6</b>	14.0	1.0 - 2.5	21M06V025	250	3000
	15.5	2.5 - 4.0	V040		
<b>M8</b>	15.5	1.0 - 2.5	21M08V025	250	2000
	17.0	2.5 - 4.0	V040		



ø : 6.1  
d1 ø : 6.0  
d2 ø : 7.0  
k : 0.5

ø : 7.1  
d1 ø : 7.0  
d2 ø : 8.0  
k : 0.5

ø : 9.1  
d1 ø : 9.0  
d2 ø : 10.0  
k : 0.5

ø : 11.1  
d1 ø : 11.0  
d2 ø : 12.0  
k : 0.5

Larger clamping capacities are available on request

Größere Klemmbereiche sind auf Anfrage lieferbar

## MFX RUBNUTS

The elastic MFX-RUBNUTS blind rivet nuts are available in various lengths and sizes with grip ranges from 0.4 up to 64 mm.

### ADVANTAGES OF MFX-RUBNUTS

- From one side applicable, using common tools.
- Absorb vibration due to high elasticity.
- Suitable for thin as well as thick plates, pipes, glass and plywood.
- Watertight seal.
- No electric conduction.
- Can be dismantled.

### EXAMPLES FOR APPLICATION

- Housing of ventilators and fans, dish washers, refrigerators, etc.
- Fixing for printcovers.
- Head lights for cars.
- Sirens and horns.
- Electronic sensors.
- Etc.

## MFX RUBNUTS

Die elastischen MFX-RUBNUTS Blindnietmuttern sind in verschiedenen Längen, Abmessungen und mit Klemmbereichen von 0.4 bis zu 64 mm erhältlich.

### VORTEILE DER MFX-RUBNUTS BLINDNIETMUTTERN

- Von einer Seite mit handelsüblichen Werkzeugen zu verarbeiten.
- Absorbieren Vibrationen durch hohe Elastizität.
- Geeignet für Metall- und Kunststoffverbindungen.
- Korrosionsbeständig.
- Elektrisch nicht leitend.
- Verbinder ist wieder lösbar.

### ANWENDUNGEN

- Ventilatorgehäuse, Geschirrspüler, Kühlschränke, usw.
- Druckerhauben.
- Autoscheinwerfer.
- Sirenen und Horne.
- Elektrische Sensore.
- Usw.

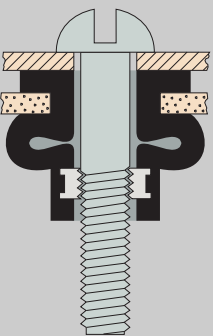
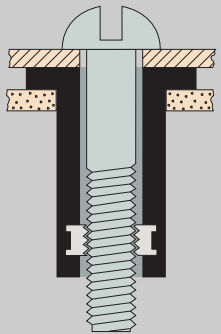
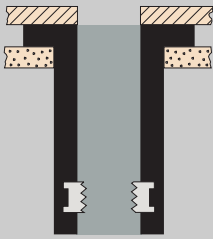
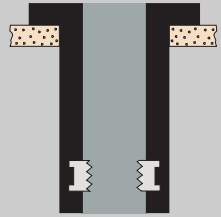

Flachkopf | Neoprene Nietkörper | Messing Gewindeeinsatz

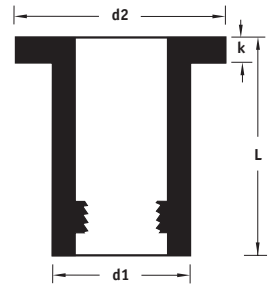

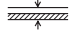
	d1 ø	ø	d2 ø	k	L		Art.	□ *
<b>M3</b>	7.9	max. 8.3	11.0	1.4	12.6	0.4 - 4.0	25M03C0040	250
<b>M4</b>	7.9	max. 8.3	11.0	1.4	12.6	0.4 - 4.0	25M04C0040	250
<b>M5</b>	9.6	max. 9.9	12.7	0.9	14.1	0.4 - 4.9	25M05C0049	250
	9.6	max. 9.9	14.0	0.9	21.5	4.0 - 11.6	C0116	
	9.6	max. 9.9	14.0	1.3	26.1	7.9 - 16.0	C0163	
	9.6	max. 9.9	14.0	1.3	39.8	20.5 - 30.0	C0300	
<b>M6</b>	12.7	max. 13.0	16.0	1.3	16.0	0.4 - 2.8	25M06C0028	250
	12.7	max. 13.0	19.1	4.75	21.1	0.8 - 4.7	C0047	
	12.7	max. 13.0	16.3	2.0	26.7	6.4 - 11.5	C0110	
	13.0	max. 13.3	16.0	1.3	35.0	11.5 - 23.0	C0230	100
<b>M8</b>	15.9	max. 16.2	22.1	3.2	18.3	0.4 - 4.0	25M08C0040	100
	15.9	max. 16.2	22.1	5.72	27.9	3.9 - 9.5	C0095	
	18.0	max. 18.3	20.0	1.6	50.0	15.0 - 39.0	C0390	50
<b>M10</b>	20.0	max. 20.3	22.5	1.3	55.0	19.0 - 40.0	25M10C0400	50
<b>M12</b>	24.0	max. 24.3	27.0	1.3	80.0	38.0 - 64.0	25M12C0640	50

\* Bulk packaging upon request

\* Groß Verpackung auf Anfrage

**steel** zinc coated

Blindnietsschrauben | MASTERBOLT | Flachkopf

**Stahl** verzinkt

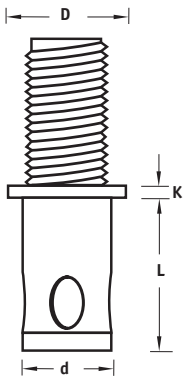

	L [+1/-0] [+/-0.5]	L 1		L 2	Art.	□
<b>M4</b>	8.0	3.5	0.5 - 2.0	10	29M042010	250
	8.0	3.5	0.5 - 2.0	15	2015	
	8.0	4.0	2.0 - 3.0	10	3010	
	8.0	4.0	2.0 - 3.0	15	3015	
<b>M5</b>	9.0	4.5	0.5 - 2.0	10	29M052010	250
	9.0	4.5	0.5 - 2.0	15	2015	
	10.5	4.5	2.0 - 3.5	10	3510	
	10.5	4.5	2.0 - 3.5	15	3515	
<b>M6</b>	10.0	5.0	0.5 - 2.5	10	29M062510	250
	10.0	5.0	0.5 - 2.5	15	2515	
	11.5	5.0	2.5 - 4.0	10	4010	
	11.5	5.0	2.5 - 4.0	15	4015	
<b>M8</b>	12.5	7.0	1.0 - 3.0	15	29M083015	250
	12.5	7.0	1.0 - 3.0	20	3020	
	15.0	7.0	3.0 - 5.0	15	5015	
	15.0	7.0	3.0 - 5.0	20	5020	

L2 = minimum length

L2 = Mindestlänge

