

CAPACITIVE SENSORS

DC + AC/DC



p-u-l-s-o-t-r-o-n-i-c

About us

In the traditional and strive industry region Chemnitz-Zwickau, directly at the freeway A72 you will find the new location of the Pulsotronic GmbH & Co.KG.

As a worldwide active company we develop and produce according to ISO 9001 proximity switches and electronic components for the following product ranges:

- > Inductive and Capacitive Sensors
- > Metal separation and Metal detection
- > Picture Processing
- > Optical Sensors
- > Magnetoresistive Sensors
- > Laser Systems
- > Colour Detection
- > Ultrasonic Sensors
- > X-Ray- Scanner

We guarantee customized solutions by our high-performance profile in the area. The available wide palette of key technologies is an ideal condition for the realization of your application.

You find the Pulsotronic everywhere there, where are to set standards and to solve task positions on the far side of well known standing types.

With innovation and individualism our competent team will advise also on place to solve your problem.

Demand us, than you will also find out:

„Pulsotronic - Here is the solution.“

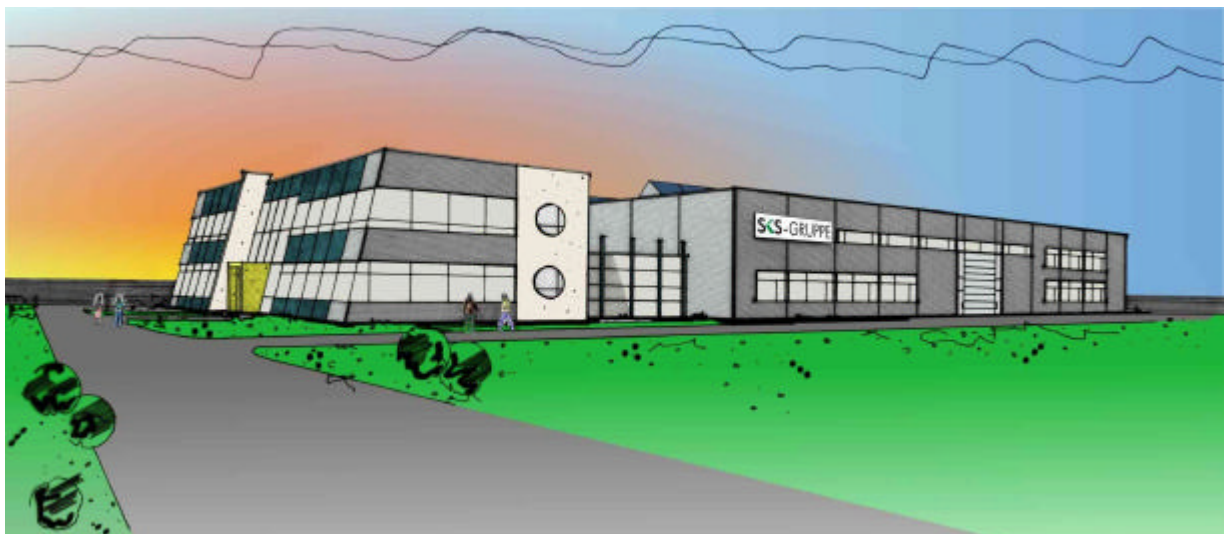

K J 10 - M 30 M B 45 - D P S - V1 - X000
T T T T T T T T T T T T
1 2 3 4 5 6 7 8 9 10 11 12

1= Working principle:	J	inductive	JR	inductive ring
			JF	inductive surface
			JG	inductive slot
			JD	full metal
	C	capacitive		
	M	magneto-resistive		
2= Switching distance / range				
3= Design:	M	cylindrical housings with metrical thread		
	G	cylindrical housings without thread		
	Q	square housings		
	D	ring housings		
4= Housing diameter / edge length				
5= Housing material:	M	brass, nickel plated	11= Kind of Connection:	V1 M8 screw / snap in
	E	stainless steel 1.4305		V2 M12 metal
	K	plastic		V2/1 M12 plastic
	A	aluminium		V3 M5 metal
				V4 Amphenol Tuchel
				V6 Brad Harrison
6= installation type:	B	shielded		V7 valve connector type A
	N	non shielded		V8 M8 only snap in
				V9 M12 only snap in
7= Tube length:		for cylindrical devices in mm		V10 valve connector type C
				V11 AC-connector 1/2" UNF
				V12 M18 plastic
8= Operating voltage:	D	DC direct-current voltage		VE Euchner connector
	AZ	AC alternating-current voltage		ZW termination box 90°
	VZ	AC/DC all voltages		RS232 data interface
				PG thread joint PG
				Mxx thread joint metrical
9= Type of the output signal:	P	PNP		more at inquiry
	N	NPN		
	Z	two-wire		
	AN	analog	ANI	current output
			ANU	voltage output
	NA	Namur		
10= Function:	S	N.O.		
	Ö	N.C.		
	A	changeover		
	U	switchable		
	I	impulse output		
	D	data interface		
12= Addition mark:	SF	weld field immune		
	T	high temperature		
	FE	reduction 1 to steel/iron		
	NF	reduction 1 to aluminium		
	X	customized design		
	W	angled sensing face / angled cable exit		
	AM	middle sensing face		

Proximity switch - Connection pictures

wiring diagrams	cable- / clampconnection	connector V1 ... V9
DPS DC PNP N.O.		
DPÖ DC PNP N.C.		
DPA DC PNP changeover		
DPU DC NO/NC switchable		
DNS DC NPN N.O.		
DNÖ DC NPN N.C.		
DNA DC NPN changeover		
DNU DC NO/NC switchable		
NA Namur DIN 19234		
DZS DC 2-wire N.O.		
DZÖ DC 2-wire N.C.		
AZS / VZS AC/DC 2-wire N.O.		
AZÖ / VZÖ AC/DC 2-wire N.C.		
Analog		

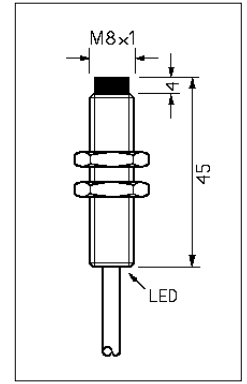
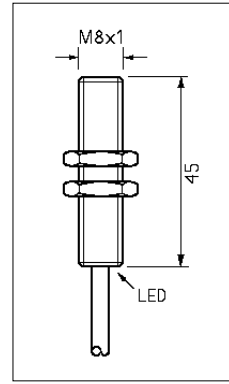
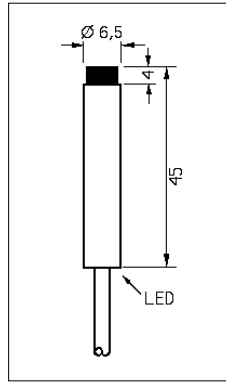
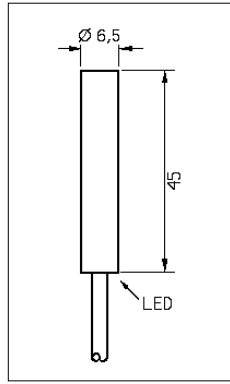

Switching Distance
Mounting

1,5 mm
Shielded

3,0 mm
Non - Shielded

1,5 mm
Shielded

3,0 mm
Non - Shielded

	Type	Type	Type	Type
PNP Normally Open	SC1,5-G6,5MB45-DPS	SC3-G6,5MN45-DPS	SC1,5-M8MB45-DPS	SC3-M8MN45-DPS
PNP Normally Close	SC1,5-G6,5MB45-DPÖ	SC3-G6,5MN45-DPÖ	SC1,5-M8MB45-DPÖ	SC3-M8MN45-DPÖ
NPN Normally Open				
NPN Normally Close				
PNP Changeover				
NPN Changeover				
Operating Voltage U_b	10 - 30 VDC	10 - 30 VDC	10 - 30 VDC	10 - 30 VDC
Ripple Voltage U_b	£ 10 %	£ 10 %	£ 10 %	£ 10 %
Voltage Drop U_d	£ 2 V	£ 2 V	£ 2 V	£ 2 V
Max. Load Current I_o	200 mA	200 mA	200 mA	200 mA
Off-State Current I_o	£ 10 mA	£ 10 mA	£ 10 mA	£ 10 mA
Leakge Current I_r	£ 10 µA	£ 10 µA	£ 10 µA	£ 10 µA
Switching Frequency f	100 Hz	100 Hz	100 Hz	100 Hz
Hysteresis H	£ 15 %	£ 15 %	£ 15 %	£ 15 %
Operating Temperature T_a	-25°C ... +70°C	-25°C ... +70°C	-25°C ... +70°C	-25°C ... +70°C
Temperature Drift	£ 10 %	£ 10 %	£ 10 %	£ 10 %
Repeat Accuracy R	£ 5 % (Sr)	£ 5 % (Sr)	£ 5 % (Sr)	£ 5 % (Sr)
Protection Class	IP 67	IP 67	IP 67	IP 67
Switching State	LED	LED	LED	LED
EMC-Standard	IEC 60947-5-2	IEC 60947-5-2	IEC 60947-5-2	IEC 60947-5-2
Housing Material	Brass Nickel-Plated	Brass Nickel-Plated	Brass Nickel-Plated	Brass Nickel-Plated
Front Cap	POM	POM	POM	POM
Termination	Cable 3 x 0,15	Cable 3 x 0,15	Cable 3 x 0,15	Cable 3 x 0,15

More special versions by separate inquiries!

Connection and Termination picture at page 3.

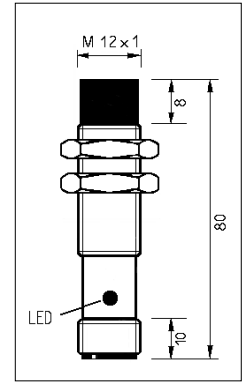
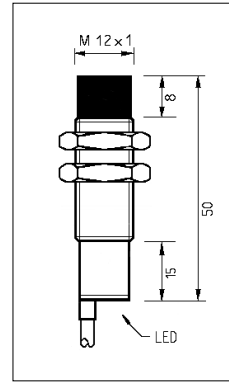
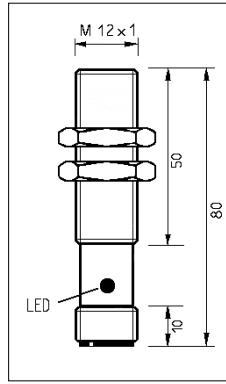
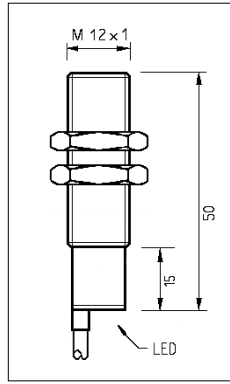

Switching Distance
Mounting

4,0 mm
Shielded

4,0 mm
Shielded

8,0 mm
Non - Shielded

8,0 mm
Non - Shielded

	Type	Type	Type	Type
PNP Normally Open	SC4-M12MB50-DPS	SC4-M12MB80-DPS-V2	SC8-M12MN50-DPS	SC8-M12MN80-DPS-V2
PNP Normally Close	SC4-M12MB50-DPÖ	SC4-M12MB80-DPÖ-V2	SC8-M12MN50-DPÖ	SC8-M12MN80-DPÖ-V2
NPN Normally Open				
NPN Normally Close				
PNP Changeover				
NPN Changeover				
Operating Voltage U_b	10 - 30 VDC	10 - 30 VDC	10 - 30 VDC	10 - 30 VDC
Ripple Voltage U_b	£ 10 %	£ 10 %	£ 10 %	£ 10 %
Voltage Drop U_d	£ 2V	£ 2 V	£ 2 V	£ 2 V
Max. Load Current I_o	200 mA	200 mA	200 mA	200 mA
Off-State Current I_o	£ 10 mA	£ 10 mA	£ 10 mA	£ 10 mA
Leakge Current I_r	£ 10 µA	£ 10 µA	£ 10 µA	£ 10 µA
Switching Frequency f	100 Hz	100 Hz	100 Hz	100 Hz
Hysteresis H	£ 15 %	£ 15 %	£ 15 %	£ 15 %
Operating Temperature T_a	-25°C ... +70°C	-25°C ... +70°C	-25°C ... +70°C	-25°C ... +70°C
Temperature Drift	£ 10 %	£ 10 %	£ 10 %	£ 10 %
Repeat Accuracy R	£ 5 % (Sr)	£ 5 % (Sr)	£ 5 % (Sr)	£ 5 % (Sr)
Protection Class	IP 67	IP 67	IP 67	IP 67
Switching State	LED	LED	LED	LED
EMC-Standard	IEC 60947-5-2	IEC 60947-5-2	IEC 60947-5-2	IEC 60947-5-2
Housing Material	Brass Nickel-Plated	Brass Nickel-Plated	Brass Nickel-Plated	Brass Nickel-Plated
Front Cap	PBT	PBT	PBT	PBT
Termination	Cable 3 x 0,34	M12 4-pol. Connector	Cable 3 x 0,34	M12 4-pol. Connector

More special versions by separate inquiries!

Connection and Termination picture at page 3.

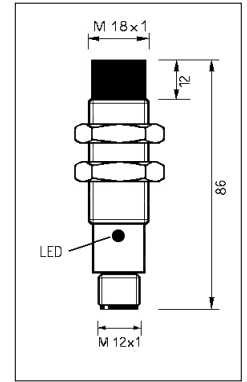
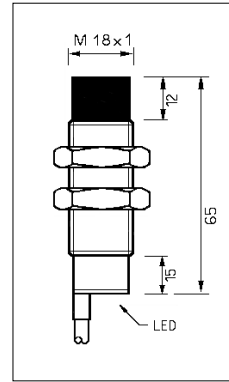
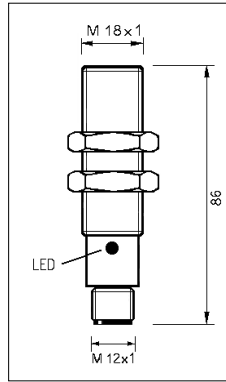
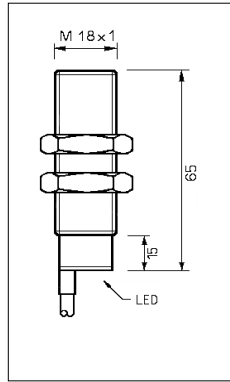

Switching Distance
Mounting

8,0 mm
Shielded

8,0 mm
Shielded

15,0 mm
Non - Shielded

15,0 mm
Non - Shielded

	Type	Type	Type	Type
PNP Normally Open	SC8-M18MB65-DPS	SC8-M18MB86-DPS-V2	SC15-M18MN65-DPS	SC15-M18MN86-DPS-V2
PNP Normally Close	SC8-M18MB65-DPÖ	SC8-M18MB86-DPÖ-V2	SC15-M18MN65-DPÖ	SC15-M18MN86-DPÖ-V2
NPN Normally Open				
NPN Normally Close				
PNP Changeover				
NPN Changeover				
Operating Voltage U_b	10 - 30 VDC	10 - 30 VDC	10 - 30 VDC	10 - 30 VDC
Ripple Voltage U_b	£ 10 %	£ 10 %	£ 10 %	£ 10 %
Voltage Drop U_d	£ 2 V	£ 2 V	£ 2 V	£ 2 V
Max. Load Current I_o	200 mA	200 mA	200 mA	200 mA
Off-State Current I_o	£ 10 mA	£ 10 mA	£ 10 mA	£ 10 mA
Leakge Current I_r	£ 10 µA	£ 10 µA	£ 10 µA	£ 10 µA
Switching Frequency f	100 Hz	100 Hz	100 Hz	100 Hz
Hysteresis H	£ 15 %	£ 15 %	£ 15 %	£ 15 %
Operating Temperature T_a	-25°C ... +70°C	-25°C ... +70°C	-25°C ... +70°C	-25°C ... +70°C
Temperature Drift	£ 10 %	£ 10 %	£ 10 %	£ 10 %
Repeat Accuracy R	£ 5 % (Sr)	£ 5 % (Sr)	£ 5 % (Sr)	£ 5 % (Sr)
Protection Class	IP 67	IP 67	IP 67	IP 67
Switching State	LED	LED	LED	LED
EMC-Standard	IEC 60947-5-2	IEC 60947-5-2	IEC 60947-5-2	IEC 60947-5-2
Housing Material	Brass Nickel-Plated	Brass Nickel-Plated	Brass Nickel-Plated	Brass Nickel-Plated
Front Cap	PBT	PBT	PBT	PBT
Termination	Cable 3 x 0,34	M12 4-pol. Connector	Cable 3 x 0,34	M12 4-pol. Connector

More special versions by separate inquiries!

Connection and Termination picture at page 3.

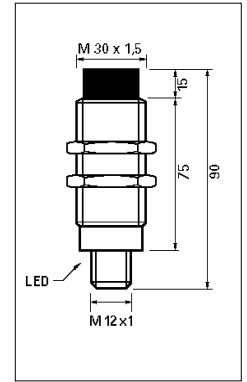
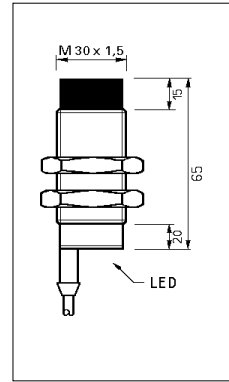
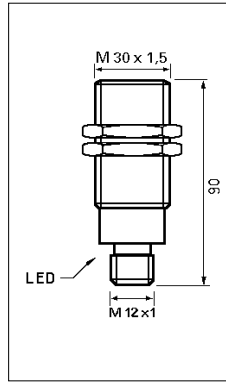
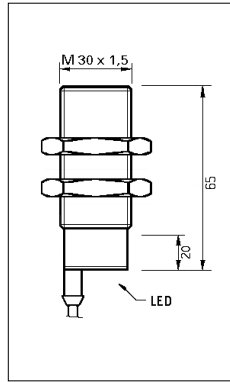

Switching Distance
Mounting

20,0 mm
Shielded

20,0 mm
Shielded

30,0 mm
Non - Shielded

30,0 mm
Non - Shielded

	Type	Type	Type	Type
PNP Normally Open	SC20-M30MB65-DPS	SC20-M30MB90-DPS-V2	SC30-M30MN65-DPS	SC30-M30MN90-DPS-V2
PNP Normally Close	SC20-M30MB65-DPÖ	SC20-M30MB90-DPÖ-V2	SC30-M30MN65-DPÖ	SC30-M30MN90-DPÖ-V2
NPN Normally Open				
NPN Normally Close				
PNP Changeover				
NPN Changeover				
Operating Voltage U_b	10 - 30 VDC	10 - 30 VDC	10 - 30 VDC	10 - 30 VDC
Ripple Voltage U_b	£ 10 %	£ 10 %	£ 10 %	£ 10 %
Voltage Drop U_d	£ 2 V	£ 2 V	£ 2 V	£ 2 V
Max. Load Current I_o	200 mA	200 mA	200 mA	200 mA
Off-State Current I_o	£ 10 mA	£ 10 mA	£ 10 mA	£ 10 mA
Leakge Current I_r	£ 10 µA	£ 10 µA	£ 10 µA	£ 10 µA
Switching Frequency f	100 Hz	100 Hz	100 Hz	100 Hz
Hysteresis H	£ 15 %	£ 15 %	£ 15 %	£ 15 %
Operating Temperature T_a	-25°C ... +70°C	-25°C ... +70°C	-25°C ... +70°C	-25°C ... +70°C
Temperature Drift	£ 10 %	£ 10 %	£ 10 %	£ 10 %
Repeat Accuracy R	£ 5 % (Sr)	£ 5 % (Sr)	£ 5 % (Sr)	£ 5 % (Sr)
Protection Class	IP 67	IP 67	IP 67	IP 67
Switching State	LED	LED	LED	LED
EMC-Standard	IEC 60947-5-2	IEC 60947-5-2	IEC 60947-5-2	IEC 60947-5-2
Housing Material	Brass Nickel-Plated	Brass Nickel-Plated	Brass Nickel-Plated	Brass Nickel-Plated
Front Cap	PBT	PBT	PBT	PBT
Termination	Cable 3 x 0,5	M12 4-pol. Connector	Cable 3 x 0,5	M12 4-pol. Connector

More special versions by separate inquiries!

Connection and Termination picture at page 3.

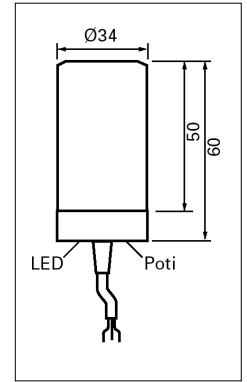
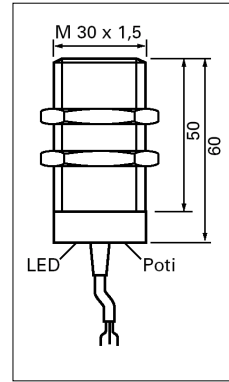
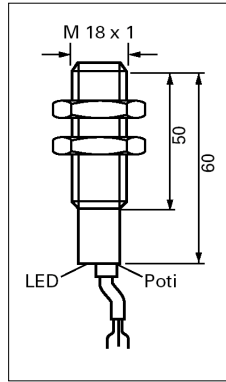
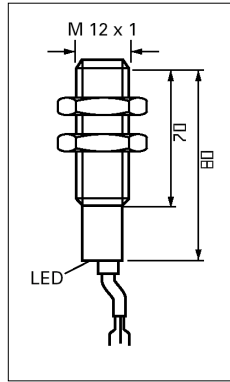

Switching Distance
Mounting

4,0 mm
Non - Shielded

8,0 mm
Non - Shielded

15,0 mm
Non - Shielded

20,0 mm
Non - Shielded

	Type	Type	Type	Type
PNP Normally Open	KC4-M12KN-DPS	KC8-M18KN-DPS	KC15-M30KN-DPS	KC20-G34KN-DPS
PNP Normally Close	KC4-M12KN-DPÖ	KC8-M18KN-DPÖ	KC15-M30KN-DPÖ	KC20-G34KN-DPÖ
NPN Normally Open				
NPN Normally Close				
PNP Changeover				
NPN Changeover				
Operating Voltage U_b	10 - 30 VDC	10 - 30 VDC	10 - 30 VDC	10 - 30 VDC
Ripple Voltage U_b	£ 10 %	£ 10 %	£ 10 %	£ 10 %
Voltage Drop U_d	£ 3 V	£ 3 V	£ 3 V	£ 3 V
Max. Load Current I_o	200 mA	200 mA	200 mA	200 mA
Off-State Current I_o	£ 20 mA	£ 20 mA	£ 20 mA	£ 20 mA
Leakge Current I_r	£ 10 µA	£ 10 µA	£ 10 µA	£ 10 µA
Switching Frequency f	15 Hz	10 Hz	10 Hz	10 Hz
Hysteresis H	£ 15 %	£ 15 %	£ 15 %	£ 15 %
Operating Temperature T_a	-25°C ... +70°C	-25°C ... +70°C	-25°C ... +70°C	-25°C ... +70°C
Temperature Drift	£ 10 %	£ 10 %	£ 10 %	£ 10 %
Repeat Accuracy R	£ 5 % (Sr)	£ 5 % (Sr)	£ 5 % (Sr)	£ 5 % (Sr)
Protection Class	IP 67	IP 67	IP 67	IP 67
Switching State	LED	LED	LED	LED
EMC-Standard	IEC 60947-5-2	IEC 60947-5-2	IEC 60947-5-2	IEC 60947-5-2
Housing Material	PA 6.6	PA 6.6	PA 6.6	PA 6.6
Front Cap	-	-	-	-
Termination	Cable 3 x 0,34	Cable 3 x 0,34	Cable 3 x 0,5	Cable 3 x 0,5

More special versions by separate inquiries!

Connection and Termination picture at page 3.

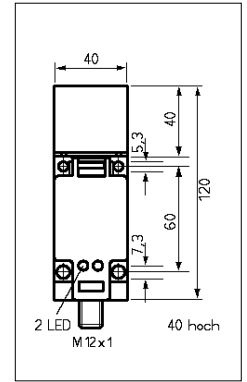
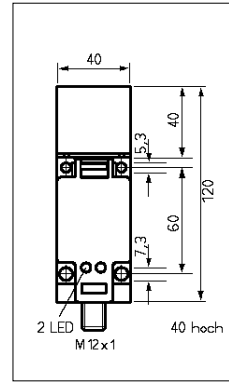
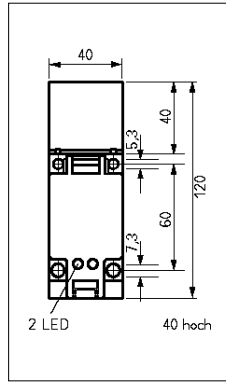
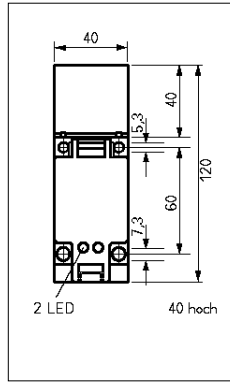

Switching Distance
Mounting

30,0 mm
Shielded

40,0 mm
Non - Shielded

30,0 mm
Shielded

40,0 mm
Non - Shielded

	Type	Type	Type	Type
PNP Normally Open				
PNP Normally Close				
NPN Normally Open				
NPN Normally Close				
PNP Changeover	SC30-Q40KB-DPA	SC40-Q40KN-DPA	SC30-Q40KB-DPA-V2	SC40-Q40KN-DPA-V2
NPN Changeover				
Operating Voltage U_b	10 - 30 VDC	10 - 30 VDC	10 - 30 VDC	10 - 30 VDC
Ripple Voltage U_b	£ 10 %	£ 10 %	£ 10 %	£ 10 %
Voltage Drop U_d	£ 2 V	£ 2 V	£ 2 V	£ 2 V
Max. Load Current I_o	200 mA	200 mA	200 mA	200 mA
Off-State Current I_o	£ 10 mA	£ 10 mA	£ 10 mA	£ 10 mA
Leakge Current I_r	£ 10 µA	£ 10 µA	£ 10 µA	£ 10 µA
Switching Frequency f	100 Hz	100 Hz	100 Hz	100 Hz
Hysteresis H	£ 15 %	£ 15 %	£ 15 %	£ 15 %
Operating Temperature T_a	-25°C ... +70°C	-25°C ... +70°C	-25°C ... +70°C	-25°C ... +70°C
Temperature Drift	£ 10 %	£ 10 %	£ 10 %	£ 10 %
Repeat Accuracy R	£ 5 % (Sr)	£ 5 % (Sr)	£ 5 % (Sr)	£ 5 % (Sr)
Protection Class	IP 67	IP 67	IP 67	IP 67
Switching State	LED	LED	LED	LED
EMC-Standard	IEC 60947-5-2	IEC 60947-5-2	IEC 60947-5-2	IEC 60947-5-2
Housing Material	PBT	PBT	PBT	PBT
Front Cap	-	-	-	-
Termination	Cable 3 x 0,5	Cable 3 x 0,5	M12 4-pol. Connector	M12 4-pol. Connector

More special versions by separate inquiries!

Connection and Termination picture at page 3.

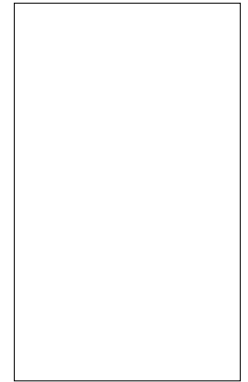
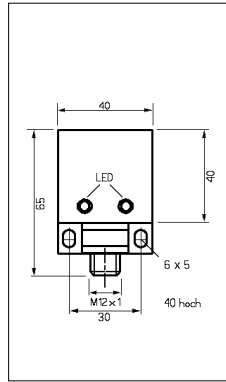
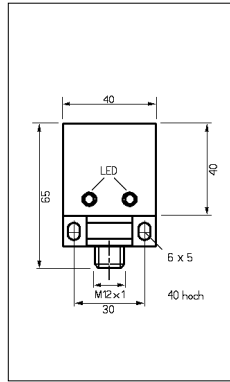

Switching Distance
Mounting

30 mm
Shielded

40 mm
Non - Shielded

	Type	Type		
PNP Normally Open				
PNP Normally Close				
NPN Normally Open				
NPN Normally Close				
PNP Changeover	SC30-Q40KB40-DPA-V2	SC40-Q40KN40-DPA-V2		
NPN Changeover				
Operating Voltage U_b	10 - 30 VDC	10 - 30 VDC		
Ripple Voltage U_b	£ 10 %	£ 10 %		
Voltage Drop U_d	£ 2 V	£ 2 V		
Max. Load Current I_o	200 mA	200 mA		
Off-State Current I_o	£ 10 mA	£ 10 mA		
Leakge Current I_r	£ 10 µA	£ 10 µA		
Switching Frequency f	100 Hz	100 Hz		
Hysteresis H	£ 15 %	£ 15 %		
Operating Temperature T_a	-25°C ... +70°C	-25°C ... +70°C		
Temperature Drift	£ 10 %	£ 10 %		
Repeat Accuracy R	£ 5 % (Sr)	£ 5 % (Sr)		
Protection Class	IP 67	IP 67		
Switching State	LED	LED		
EMC-Standard	IEC 60947-5-2	IEC 60947-5-2		
Housing Material	PBT	PBT		
Front Cap	-	-		
Termination	M12 4-pol. Connector	M12 4-pol. Connector		

More special versions by separate inquiries!

Connection and Termination picture at page 3.

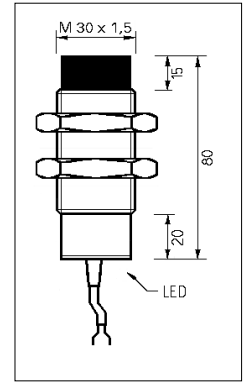
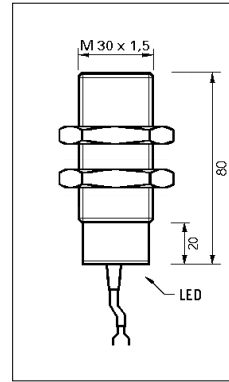
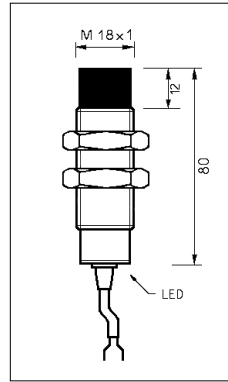
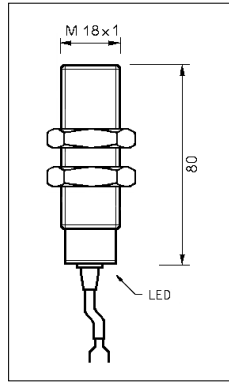

Switching Distance	8,0 mm	15,0 mm	15,0 mm	20,0 mm
Mounting	Shielded	Non - Shielded	Shielded	Non - Shielded
Type				
AC Normally Open				
AC Normally Close				
AC/DC Normally Open	SC8-M18MB80-VZS	SC15-M18MN80-VZS	SC15-M30MB80-VZS	SC20-M30MN80-VZS
AC/DC Normally Close	SC8-M18MB80-VZÖ	SC15-M18MN80-VZÖ	SC15-M30MB80-VZÖ	SC20-M30MN80-VZÖ
AC/DC Switchable				
Operating Voltage U_b	20 - 250 V AC/DC	20 - 250 V AC/DC	20 - 250 V AC/DC	20 - 250 V AC/DC
Voltage Frequency	50/60 Hz	50/60 Hz	50/60 Hz	50/60 Hz
Voltage Drop U_d	£ 10 VDC / 8 VAC	£ 10 VDC / 8 VAC	£ 10 VDC / 8 VAC	£ 10 VDC / 8 VAC
Max. Load Current I_o	200 mA	200 mA	200 mA	200 mA
Min. Load Current I_{emin}	5 mA	5 mA	5 mA	5 mA
Leakge Current I_r	£ 2,5 mA	£ 2,5 mA	£ 2,5 mA	£ 2,5 mA
Surge Current I_k	2,2 A (20 ms)	2,2 A (20 ms)	2,2 A (20 ms)	2,2 A (20 ms)
Switching Frequency f	AC 25 Hz / DC 40 Hz	AC 25 Hz / DC 40 Hz	AC 25 Hz / DC 40 Hz	AC 25 Hz / DC 40 Hz
Hysteresis H	£ 15 %	£ 15 %	£ 15 %	£ 15 %
Operating Temperature T_a	-25°C ... +70°C	-25°C ... +70°C	-25°C ... +70°C	-25°C ... +70°C
Temperature Drift	£ 1 - 15 %	£ 1 - 15 %	£ 1 - 15 %	£ 1 - 15 %
Repeat Accuracy R	£ 1 %	£ 1 %	£ 1 %	£ 1 %
Protection Class	IP 67	IP 67	IP 67	IP 67
Switching State	LED	LED	LED	LED
EMC-Standard	EN 60947-5-2	EN 60947-5-2	EN 60947-5-2	EN 60947-5-2
Housing Material	Brass Nickel-Plated	Brass Nickel-Plated	Brass Nickel-Plated	Brass Nickel-Plated
Front Cap	PBT	PBT	PBT	PBT
Termination	Cable 2 x 0,34	Cable 2 x 0,34	Cable 2 x 0,5	Cable 2 x 0,5

More special versions by separate inquiries!

Connection and Termination picture at page 3.

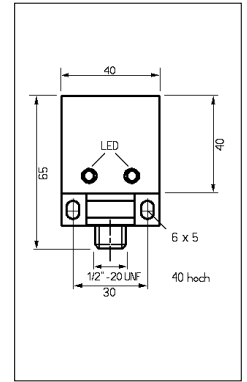
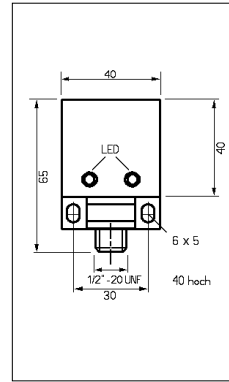
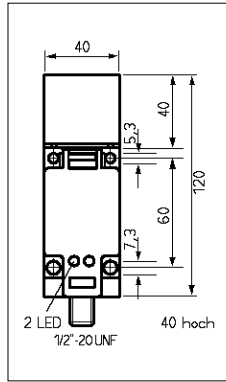
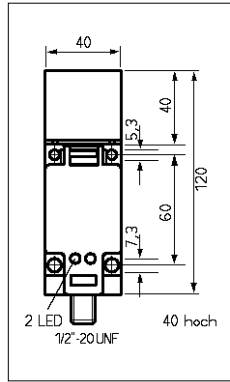

Switching Distance
Mounting

30,0 mm
Shielded

40,0 mm
Non - Shielded

30,0 mm
Shielded

40,0 mm
Non - Shielded

	Type	Type	Type	Type
AC Normally Open				
AC Normally Close				
AC/DC Normally Open	SC30-Q40KB-VZS-V11	SC40-Q40KN-VZS-V11	SC30-Q40KB40-VZS-V11	SC40-Q40KN40-VZS-V11
AC/DC Normally Close	SC30-Q40KB-VZÖ-V11	SC40-Q40KN-VZÖ-V11	SC30-Q40KB40-VZÖ-V11	SC40-Q40KN40-VZÖ-V11
AC/DC Switchable				
Operating Voltage U_b	20 - 250 V AC/DC	20 - 250 V AC/DC	20 - 250 V AC/DC	20 - 250 V AC/DC
Voltage Frequency	50/60 Hz	50/60 Hz	50/60 Hz	50/60 Hz
Voltage Drop U_d	£ 10 VDC / 8 VAC	£ 10 VDC / 8 VAC	£ 10 VDC / 8 VAC	£ 10 VDC / 8 VAC
Max. Load Current I_o	200 mA	200 mA	200 mA	200 mA
Min. Load Current I_{emin}	5 mA	5 mA	5 mA	5 mA
Leakge Current I_r	£ 2,5 mA	£ 2,5 mA	£ 2,5 mA	£ 2,5 mA
Surge Current I_k	2,2 A (20 ms)	2,2 A (20 ms)	2,2 A (20 ms)	2,2 A (20 ms)
Switching Frequency f	AC 25 Hz / DC 40 Hz	AC 25 Hz / DC 40 Hz	AC 25 Hz / DC 40 Hz	AC 25 Hz / DC 40 Hz
Hysteresis H	£ 15 %	£ 15 %	£ 15 %	£ 15 %
Operating Temperature T_a	-25°C ... +70°C	-25°C ... +70°C	-25°C ... +70°C	-25°C ... +70°C
Temperature Drift	£ 1 - 15 %	£ 1 - 15 %	£ 1 - 15 %	£ 1 - 15 %
Repeat Accuracy R	£ 1 %	£ 1 %	£ 1 %	£ 1 %
Protection Class	IP 67	IP 67	IP 67	IP 67
Switching State	LED	LED	LED	LED
EMC-Standard	EN 60947-5-2	EN 60947-5-2	EN 60947-5-2	EN 60947-5-2
Housing Material	PBT Resin	PBT Resin	PBT Resin	PBT Resin
Front Cap	-	-	-	-
Termination	1/2''-20 UNF	1/2''-20 UNF	1/2''-20 UNF	1/2''-20 UNF

More special versions by separate inquiries!

Connection and Termination picture at page 3.

Table of contents

Type	Art-Nr.	Site	Type	Art-Nr.	Site
G6,5			M30		
SC1,5-G6,5MB45-DPS	08323650151	4	KC15-M30KN-DPS	08320000020	8
SC1,5-G6,5MB45-DPÖ	08323650152	4	KC15-M30KN-DPÖ	08320000335	8
SC3-G6,5MN45-DPS	08323650310	4	SC15-M30MB80-VZS	08323301570	11
SC3-G6,5MN45-DPÖ	08323650320	4	SC15-M30MB80-VZÖ	08323301580	11
M8			SC20-M30MB65-DPS	08323302010	7
SC1,5-M8MB45-DPS	08323080151	4	SC20-M30MB65-DPÖ	08323302020	7
SC1,5-M8MB45-DPÖ	08323080152	4	SC20-M30MN80-VZS	08323302070	11
SC3-M8MN45-DPS	08323080310	4	SC20-M30MN80-VZÖ	08323302080	11
SC3-M8MN45-DPÖ	08323080320	4	SC20-M30MB90-DPS-V2	08323302012	7
M12			SC20-M30MB90-DPÖ-V2	08323302022	7
SC4-M12MB50-DPS	08323120410	5	SC30-M30MN65-DPS	08323303010	7
SC4-M12MB50-DPÖ	08323120420	5	SC30-M30MN65-DPÖ	08323303020	7
KC4-M12KN-DPS	08320000003	8	SC30-M30MN90-DPS-V2	08323303012	7
KC4-M12KN-DPÖ	08320000019	8	SC30-M30MN90-DPÖ-V2	08323303022	7
SC4-M12MB80-DPS-V2	08323120412	5	G34		
SC4-M12MB80-DPÖ-V2	08323120422	5	KC20-G34KN-DPS	08329668400	8
SC8-M12MN50-DPS	08323120810	5	KC20-G34KN-DPÖ	08329668600	8
SC8-M12MN50-DPÖ	08323120820	5	Q40		
SC8-M12MN80-DPS-V2	08323120812	5	SC30-Q40KB-DPA	08323403050	9
SC8-M12MN80-DPÖ-V2	08323120822	5	SC40-Q40KN-DPA	08323404050	9
M18			SC30-Q40KB-DPA-V2	08323403052	9
KC8-M18KN-DPS	08320000397	8	SC40-Q40KN-DPA-V2	08323404052	9
KC8-M18KN-DPÖ	08320000407	8	SC30-Q40KB40-DPA-V2	08323304052	10
SC8-M18MB65-DPS	08323180810	6	SC40-Q40KN40-DPA-V2	08323404152	10
SC8-M18MB65-DPS	08323180820	6	SC30-Q40KB-VZS-V11	08323403070	12
SC8-M18MB80-VZS	08323180870	11	SC30-Q40KB-VZÖ-V11	08323403080	12
SC8-M18MB80-VZÖ	08323180880	11	SC40-Q40KN-VZS-V11	08323404070	12
SC8-M18MB86-DPS-V2	08323180812	6	SC40-Q40KN-VZÖ-V11	08323404080	12
SC8-M18MB86-DPÖ-V2	08323180822	6	SC30-Q40KB40-VZS-V11	08323304070	12
SC15-M18MN65-DPS	08323181510	6	SC30-Q40KB40-VZÖ-V11	08323304080	12
SC15-M18MN65-DPÖ	08323181520	6	SC40-Q40KN40-VZS-V11	08323404170	12
SC15-M18MN80-VZS	08323181570	11	SC40-Q40KN40-VZÖ-V11	08323404180	12
SC15-M18MN80-VZÖ	08323181580	11			
SC15-M18MN86-DPS-V2	08323181512	6			
SC15-M18MN86-DPÖ-V2	08323181522	6			

AUSTRALIA

PCA Plant Control & Automation Pty
LTD
Unit 3 No. 3 Hunter Street
2077 Hornsby NSW
Tel. 00 61 / 29 48 23 73 3
Fax 00 61 / 29 47 66 82 2
E-mail: sales@pca-us.com.au

CZECH REPUBLIC

Bibus S.R.O.
Videnská 125
63927 Brno
Tel. 00 42 / 05 47 12 53 24
Fax 00 42 / 05 47 12 53 10
E-mail: duchon@bibus.cz

FRANCE

Verco France
32, Rue Commandant Fuzier
Tel. 00 33 / 47 28 44 10 5
Fax 00 33 / 47 86 26 02 3
E-mail: verco@alyon.org

ITALY

Tritecnica S.R.L.
Viale Lazio 26
20135 Milano
Tel. 00 39 / 02-54 19 45 2
Fax 00 39 / 02-55 18 12 97
E-mail: info@tritecnica.it

NETHERLANDS

Solar Elektro B.V.
Effect 5
6921 RG Duiven
Tel. 00 31 / 26 36 52 91
Fax 00 31 / 26 36 52 34 6
E-mail: algemeen@beng.nl

SPAIN

Automatica Electronica
Y Control S.L.
08018 Barcelona
Tel. 00 34 / 93 48 50 034
Fax 00 34 / 93 48 50 296
E-mail: p.dalmases@automatica-elec.es

SWEDEN

Tillquist Elteknik AB
Finlandsgatan 16
16422 Kista
Tel. 00 46 / 8-59 46 32 00
Fax 00 46 / 8-75 13 69 5
E-mail: info@tillquisteltechnik.se

SWITZERLAND

Ymatron AG
Brüelstraße 7
8157 Dielsdorf
Tel. 0041 / 18 55 23 88
Fax 0041 / 18 55 23 81
Email: info@ymatron.ch

USA

Altech Corp.
35 Royal Road
08822 Flemington NJ-6000
Tel. 00 1 / 90 88 06 94 00
Fax 00 1 / 90 88 06 94 9
E-mail: info@altechcorp.com

BELGIUM

Bintz Technics N.V.
Business Park
Brixtonlaan 25
1930 Zaventem
Tel. 00 32 / 27 20 49 16
Fax 00 32 / 27 20 37 50
E-Mail: beyens@bintz-technics.be

DENMARK

Scancomp
Bøgedals Allé 18
DK 5250 Odense SV
Tel. 00 45 / 66 11 29 89
Fax 00 45 / 66 11 29 63
E-mail: mh@scancomp.dk
Internet: www.scancomp.dk

GREECE

Panayiotis Vassiliou S.A.
91, Achamon
10440 Athen
Te. 00 30 / 21 05 22 27 11
Fax 0030 / 21 05 24 67 5
E-mail: vasben@otenet.gr

JAPAN

System Electronic Co. Ltd.
2-13-3 Yayoi- Bunkyo-Ku
Tokyo
Tel. 0081 / 3 5803 7151
Fax 0081 / 3 5803 7152
E-mail: Isao@system-electronic-japan.co.jp

POLAND

P.W. Romex
Roman Siecla
UL. Wzlotowa 5
60411 Poznan
Tel. 00 48 / 61 84 17 82 4
Fax 00 48 / 61 84 36 34 3
E-mail: siecla.r@pwrromex.com.pl

SOUTH KOREA

EURO Corperation
Room Nr. 103
Tae Sung BLDG 199-1
Jangsa-Dorg Jongro-Ku
Tel. 00 82 / 2-22 63 14 96 7
Fax 00 82 / 2-22 63 14 98
E-mail: europilz@chol.com

SWITZERLAND

Quarz AG
Wiesenstraße 2
8617 Mönchaltorf
Tel. 00 41 / 19 48 18 48
Fax 00 41 / 19 48 09 09
E-mail: robo@quarz.ch

SOUTH AFRICA

Countapulse Controls
Pty. Ltd.
P.O. Box 40393
Cleveland, 2022
Tel. 00 27 / 11-61 57 55 6
Fax 00 27 / 11-61 57 51 3
E-mail: clive@countapulse.co.za

CANADA

Sircon Controls Ltd.
5359 Timberlea Blvd., Unit 36
L4W4N5 Ontario
Tel. 00 1 / 90 5-23 89 50 5
Fax 00 1 / 90 5-23 88 38 0
E-mail: info@sirconcontrols.co

FINLAND

SKS-Automaatio Oy
Martinkyläntie 50
01721 Vantaa
Tel. 00 35 8 / 9-85 26 61
Fax 00 35 8 / 9-85 26 82 0
E-mail: sks-automaatio@sks.fi

ISRAEL

E.I.D. Electronics Ltd.
5, Saphir Street
Ramat Gan, 52622
Tel.00 97 / 2-3-53 43 38 0
Fax 00 97 / 2-3-53 43 38 5
E-mail: eidelec@attglobal.net

NETHERLANDS

SEN-TECH Benelux B.V.
Middelweg 8 e
5253 CA Nieuwkuijk
Tel. 00 31 / 73 51 83 12 1
Fax 00 31 / 73 51 83 12 2
E-mail: info@sentech.nl

SLOVAKIA

Bibus SK S.R.O.
Priemyselna 4
94901 Nitra
Tel. 00 42 / 1-3 77 41 25 25
Fax 0042 / 1-3 77 51 67 01
E-mail: gyenes@bibus.sk

SWEDEN

Octab Industrieelektronik AB
Leif Bergquist
Maskingatan 8B
19560 Märsta
Tel. 00 46 / 8-59 11 50 00
Fax 00 46 / 8-59 11 50 01
Email:info@octab.se

SWITZERLAND

Spälti Schaltgeräte AG
Wässerstraße 25
8340 Hinwil
Tel. 00 41 / 1-93 88 09 0
Fax 00 41 / 1-93 88 09 1
E-mail: spaelti-ag@swissonline.ch

TAIWAN

DWO & TOM Enterprise Co.
Majestic Trading Co. Ltd.
No. 178-4-Sec. 2
Chang an E. Road
Taipei Taiwan R.O.C.
Tel. 00 88 6 / 22 75 28 15 1
Fax 00 88 6 / 22 75 11 86 8
E-mail: dwotom@so-net.tw

Distribution office:

Postcode area:
16, 17, 18, 19, 20-29,
30, 31, 32, 38, 39, 49
Uwe Reisewitz
Waakhauserstraße 9
D-28719 Bremen
Phone: +49 4 21 / 64 26 44
Fax: +49 4 21 / 64 40 28 1
Mobile: +49 1 71 / 63 75 86 8

Postcode area:
40, 41, 42, 44, 45, 46, 47, 48,
50, 51, 52, 53, 54, 55, 56
Christoph Gilgenberg
Pascalstraße 22
D-53840 Troisdorf
Phone: +49 22 41 / 97 41 24
Fax: +49 22 41 / 97 30 63
Mobile: +49 1 71 / 63 75 86 6

Postcode area:
33-37, 57, 58, 59, 60,
61, 63, 64, 65, 68, 69
Konrad Wiegand
Am Heydewolf 6
D-35274 Kirchhain
Phone: +49 64 22 / 92 29 23
Fax: +49 64 22 / 92 29 24
Mobile: +49 1 71 / 63 75 86 3

Postcode area:
01-04, 08-10, 12, 13,
14, 15
Mark Braun
Neue Schichtstraße 14
D-09366 Niederdorf
Phone: +49 3 72 96 / 930 203
Fax: +49 3 72 96 / 930 187
Mobile: +49 1 71 / 637 58 57

Postcode area:
66, 67, 77, 78,
79, 721, 722
SKA Tec GmbH & Co. KG
Dieter Schley
Alemannenstraße 53
D-77767 Appenweier
Phone.: +49 78 05 / 99 85 0
Fax: +49 78 05 / 91 02 55

Postcode area:
80, 81, 82, 83, 84, 85,
90, 91, 92, 93, 94
Adolf Hutner
Ascherbachweg 2a
D-85232 Neuhimmelreich
Phone: +49 81 31 / 35 08 73
Fax: +49 81 31 / 35 08 72
Mobile: +49 1 71 / 63 75 86 2

Postcode area:
92, 93, 95, 96, 97
C + R Automation GmbH
Christian Rott
Weinzierleiner Straße 9
D-90513 Zirndorf
Phone: +49 9 11 / 60 43 67
Fax: +49 9 11 / 600 24 09
Mobile: +49 1 70 / 798 72 39

Postcode area:
70, 71, 72, 73, 74, 75,
76, 86, 87, 88, 89
Andreas Barth
Vogelstraße 15
D-89269 Vöhringen
Phone: +49 73 06 / 92 40 82
Fax: +49 73 06 / 92 24 61
Mobile: +49 1 71 / 63 75 85 6

Postcode area:
06, 07, 98, 99
Riese Electronic GmbH
Thomas Schüler
Schleizerstraße 36 - 38
D-07937 Zeulenroda
Phone: +49 3 66 28 / 725 11
Fax: +49 3 66 28 / 725 17
Mobile: +49 1 72 / 367 13 62



p·u·l·s·o·t·r·o·n·i·c

Pulsotronic GmbH & Co. KG

Neue Schichtstraße 14

D-09366 Niederdorf

Phone +49 37 296 / 930 100

Telefax +49 37 296 / 930 180

info@pulsotronic.de

www.pulsotronic.de